

HSF

NOTES:

Current Rating: 1.0 AMP
 Contact Resistance: 20milliohm Max
 Withstand Voltage: 250V AC/DC
 Insulation Resistance: 1000Megohtm Min
 Operation Temperature: -25°C to +85°C
 Housing Material: PA9T+30%GF(UL94V-0)
 Contact Material: Brass
 Contact plating: Au/Sn over Ni Plating

Ordering Information

WF1001-WM XX E 0 1

No. of Pins 2P-20P
 Insulator Color: W=White, E=Beige
 Packing: A=Tray, T=Tube, 0=PE Bag, R=Tube & Reel, P=Tube +CAP

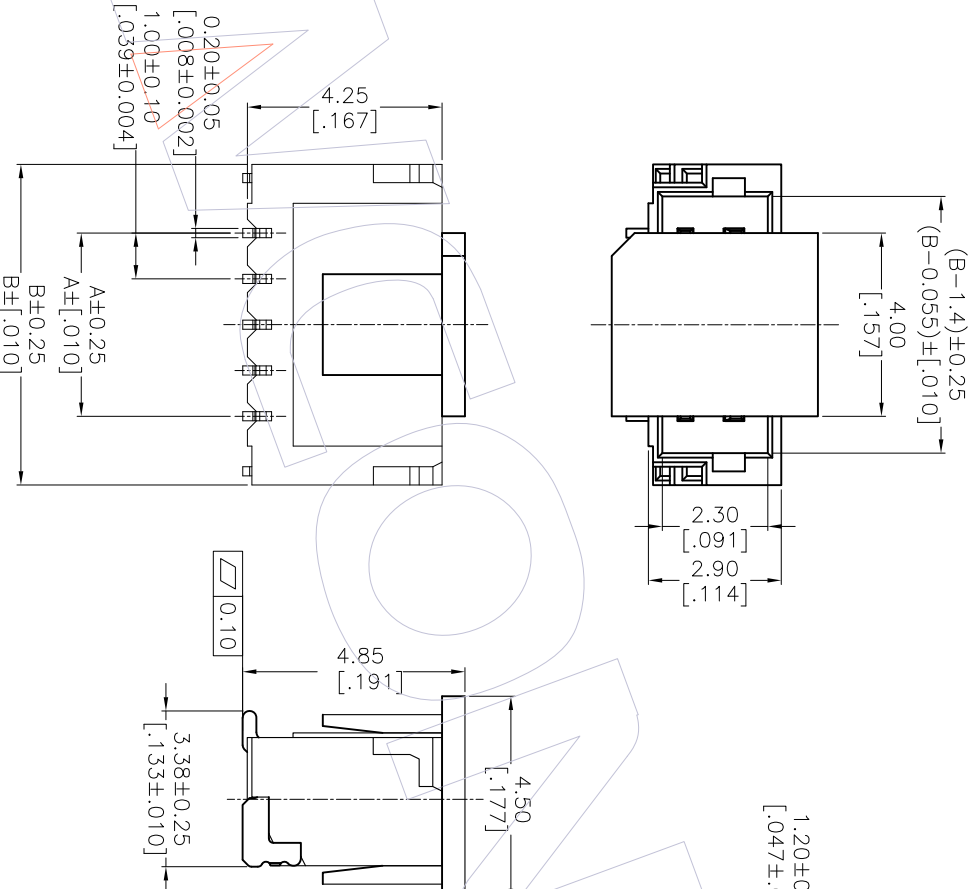

RECOMMENDED PCB LAYOUT
 TOLERANCE IS ±0.05

Part No.	Dimension	
	DIM A	DIM B
WF1001-WM02E01	1.00 [0.039]	4.00 [0.158]
WF1001-WM03E01	2.00 [0.079]	5.00 [0.197]
WF1001-WM04E01	3.00 [0.118]	6.00 [0.236]
WF1001-WM05E01	4.00 [0.158]	7.00 [0.276]
WF1001-WM06E01	5.00 [0.197]	8.00 [0.315]
WF1001-WM07E01	6.00 [0.236]	9.00 [0.355]
WF1001-WM08E01	7.00 [0.276]	10.00 [0.394]
WF1001-WM09E01	8.00 [0.315]	11.00 [0.433]
WF1001-WM10E01	9.00 [0.355]	12.00 [0.473]
WF1001-WM11E01	10.00 [0.394]	13.00 [0.512]
WF1001-WM12E01	11.00 [0.433]	14.00 [0.551]
WF1001-WM13E01	12.00 [0.473]	15.00 [0.591]
WF1001-WM14E01	13.00 [0.512]	16.00 [0.630]
WF1001-WM15E01	14.00 [0.551]	17.00 [0.670]
WF1001-WM16E01	15.00 [0.591]	18.00 [0.709]
WF1001-WM17E01	16.00 [0.630]	19.00 [0.748]
WF1001-WM18E01	17.00 [0.670]	20.00 [0.788]
WF1001-WM19E01	18.00 [0.709]	21.00 [0.827]
WF1001-WM20E01	19.00 [0.748]	22.00 [0.866]

REV	DATE	MODIFICATION DESCRIPTION	CHANGE	OPERATION	DRAW	DATE	SCALE	PART NO.
A1	2013.04.18	Add CAP	XSF	X.XX ±0.40	Riley	2011.12.20	1:1 mm	WF1001-WMXXXE01
A0	2011.12.20	NEW	-	X.XXX ±0.15 Angle ± 3° DIM TOL	CHECK APPROVE	DATE	UNIT A4 SHEET 1/1 PROJ.	TITLE: J SH 1.0mm Wafer 180度SMT Customer NO.

WCON

Http://www.wcon.com

WCON - Dongguan
 Tel: +86 769 85358920
 Fax: +86 769 85358915
 E-mail: sales@wcon.com

WCON - Kunshan
 Tel: +86 512 57468408
 Fax: +86 512 57468468
 E-mail: wcon@wcon.com