

# HSF

**NOTES:**

Current Rating:8A  
 Voltage Rating:300V  
 Contact Resistance:8milliohm Max  
 Withstand Voltage:AC2000V  
 Insulation Resistance:1000Megohm Min  
 Operation Temperature:-40℃ to +105℃

Housing Material:PA66+30%GF (UL94V-0)  $\Delta 3$   
 Contact Material:Brass  
 Inlay Material:Brass

Recommended P.C.B Layout (Top Side)  
 (PCB BOARD TOLERANCE $\pm 0.05$ )

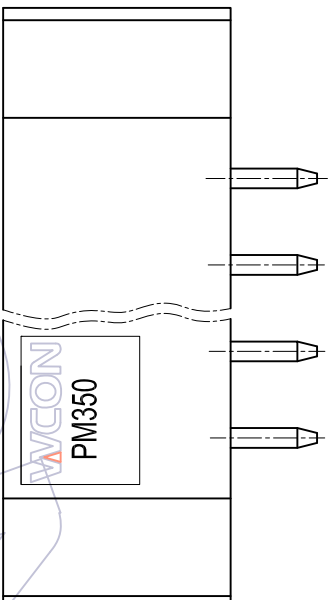
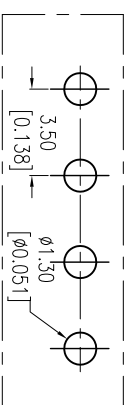

**Ordering Information:**

**P M 350 - 1 S XX A SM 2**

M=Male Pitch 350=3.50  
 No.of Pins 02=20P Color Contact Plated Series No. A=Green SM=Matte Tin

11P	48.80 ±0.30	35.00 ±0.30		
10P	45.30 ±0.30	31.50 ±0.30	20P	80.30 ±0.40
9P	41.80 ±0.30	28.00 ±0.30	19P	76.80 ±0.40
8P	38.30 ±0.20	24.50 ±0.20	18P	73.30 ±0.40
7P	34.80 ±0.20	21.00 ±0.20	17P	69.80 ±0.40
6P	31.30 ±0.20	17.50 ±0.20	16P	66.30 ±0.40
5P	27.80 ±0.20	14.00 ±0.20	15P	62.80 ±0.40
4P	24.30 ±0.20	10.50 ±0.20	14P	59.30 ±0.30
3P	20.80 ±0.20	7.00 ±0.20	13P	55.80 ±0.30
2P	17.30 ±0.20	3.50 ±0.10	12P	52.30 ±0.30
PIN	A	B	PIN	A

ITEM	Pitch	Mating
Standard	3.50	PT350
Alternate		

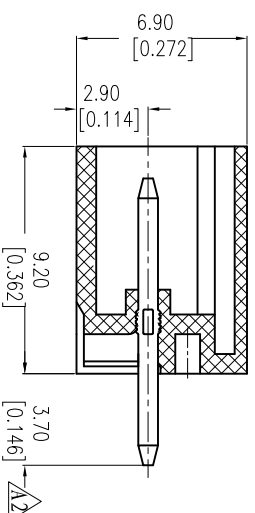
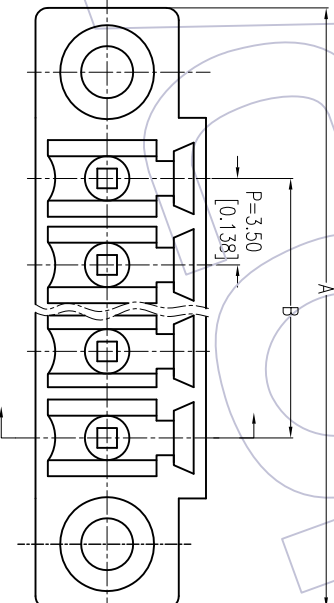

A3	2013/06/05	Modify The Housing Material	$\Delta 3$	OPERATION	DRAW	DATE	SCALE	FIT	PART NO.	TITLE: 3.50mm Pitch Male Pluggable Terminal Blocks Customer NO.	WCON-Dongguan Tel: +86 769 85358920 Fax: +86 769 85358915 E-mail: sales@wcon.com	WCON-Kunshan Tel: +86 512 57468408 Fax: +86 512 57468468 E-mail: sales@wcon.com
A2	2013/04/24	Modify The Dimension 3.50 To 3.70	$\Delta 3$	XX	Tsingn	2013/06/05	UNIT	mm	PM350-1SXXASM2 $\Delta 3$			
A1	2012/05/09	MODIFY PF350-02-XX-A-SM → PM350-1SXXASM2	$\Delta 3$	X.XX	CHECK	DATE	SIZE	A4				
A0	2011/06/07	NEW		X.XXX		DATE	SHEET	1/1				
REV	DATE	MODIFICATION DESCRIPTION	CHANGE	Angle	APPROVE	DATE	PROJ.					
1				$\pm 3^\circ$								
2				TOL								
3												
4												
5												
6												
7												
8												
9												
10												

# WCON

Http: www.wcon.com