

# HSF

**NOTES:**

Rated Current: 3.0A  
 Contact Resistance: 20mΩ max  
 Withstand Voltage: 1000V AC/Minute  
 Insulation Resistance: 1000MΩ min  
 Operation Temperature: -25℃ to +85℃  
 Contact Material: Brass  
 Contact plating: Au Or Sn Over Ni  
 Insulator Material: PA66 (UL94V-0)

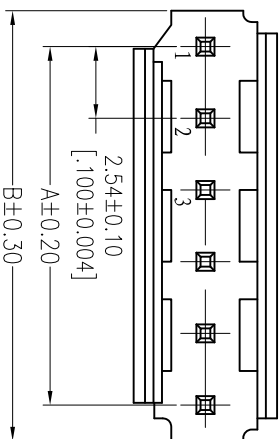

## Ordering Information

WF2547 - 1 WS XX XXX X 1

No. of Row Single Row  
 Contact Plating  
 W=Gold Flash/Tin  
 S3=10u"Gold/Tin  
 S5=30u"Gold/Tin  
 S4=15u"Gold/Tin  
 S2P=20P  
 Color  
 W=White A=Tray  
 U=Blue B=Black  
 R=Tube  
 Packing  
 T=Tray  
 R=Tube&Reel

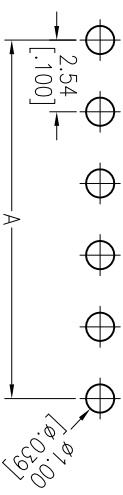
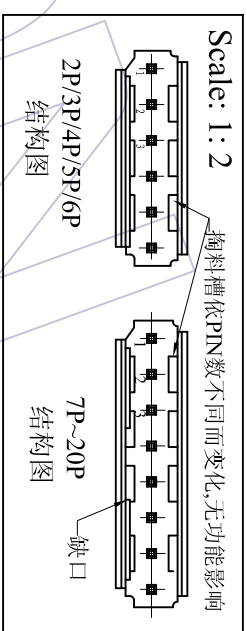
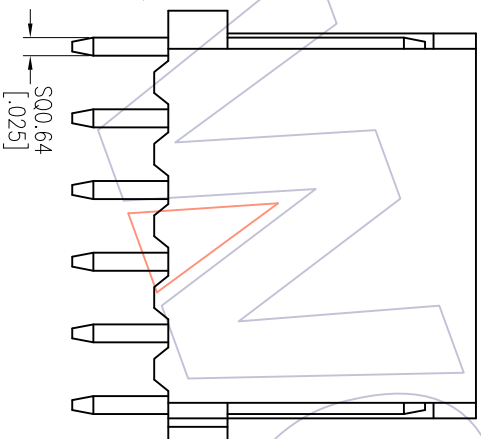

Recommended P.C.B Layout(Top Side)  
 (PCB BOARD TOLERANCE±0.05)

Circuit	Part No.	Dimension	
		A	B
02	WF2547-1WS02XX1	2.54	5.08
03	WF2547-1WS03XX1	5.08	7.62
04	WF2547-1WS04XX1	7.62	10.16
05	WF2547-1WS05XX1	10.16	12.70
06	WF2547-1WS06XX1	12.70	15.24
07	WF2547-1WS07XX1	15.24	17.78
08	WF2547-1WS08XX1	17.78	20.32
09	WF2547-1WS09XX1	20.32	22.86
10	WF2547-1WS10XX1	22.86	25.40
11	WF2547-1WS11XX1	25.40	27.94
12	WF2547-1WS12XX1	27.94	30.48
13	WF2547-1WS13XX1	30.48	33.02
14	WF2547-1WS14XX1	33.02	35.56
15	WF2547-1WS15XX1	35.56	38.10
16	WF2547-1WS16XX1	38.10	40.64
17	WF2547-1WS17XX1	40.64	43.18
18	WF2547-1WS18XX1	43.18	45.72
19	WF2547-1WS19XX1	45.72	48.26
20	WF2547-1WS20XX1	48.26	50.80

REV	DATE	MODIFICATION DESCRIPTION	CHANGE
AO	2012/09/08	NEW	

OPERATION	SCALE	FIT	PART NO.
X.X	mm	1/1	SEE TAB
X.XX	mm	A4	TITLE: "T" TYPE 2.54 WAFER SINGLE ROW 180°
X.XXX	mm	1/1	Customer NO.
Angle	SHEET		
± 3'	1/1		
DIM	PROJ.		

**WCON**  
 Http: www.wcon.com

WCON-Dongguan  
 Tel: +86 769 85358920  
 Fax: +86 769 85358915  
 E-mail: sales@wcon.com

WCON-Kunshan  
 Tel: +86 512 57468408  
 Fax: +86 512 57468468  
 E-mail: sales@wcon.com