

# HSF

### NOTES:

- Rated Voltage:100V AC/DC
- Rated Current:1.0AMP
- Contact Resistance:20mΩ max
- Withstand Voltage:500V AC/DC
- Insulation Resistance:100MΩ min
- Operation Temperature:-25℃ to +85℃
- Contact Material:Brass
- Contact plating:Au Or Sn Over Ni
- Insulator Material:PA6T+30%G.F UL94V-0

## Ordering Information

WF1251 - WS XX X X 1

No. of pins Contact Plating  
02~15P S0=Gold Flash/Tin  
S3=10u"Gold/Tin  
S4=15u"Gold/Tin  
S5=30u"Gold/Tin  
G0=Gold Flash  
G3=10u"Gold  
G4=15u"Gold  
G5=30u"Gold  
Blank=Tin

Color  
W=Natural  
A=Tray  
T=Tube  
R=Reel

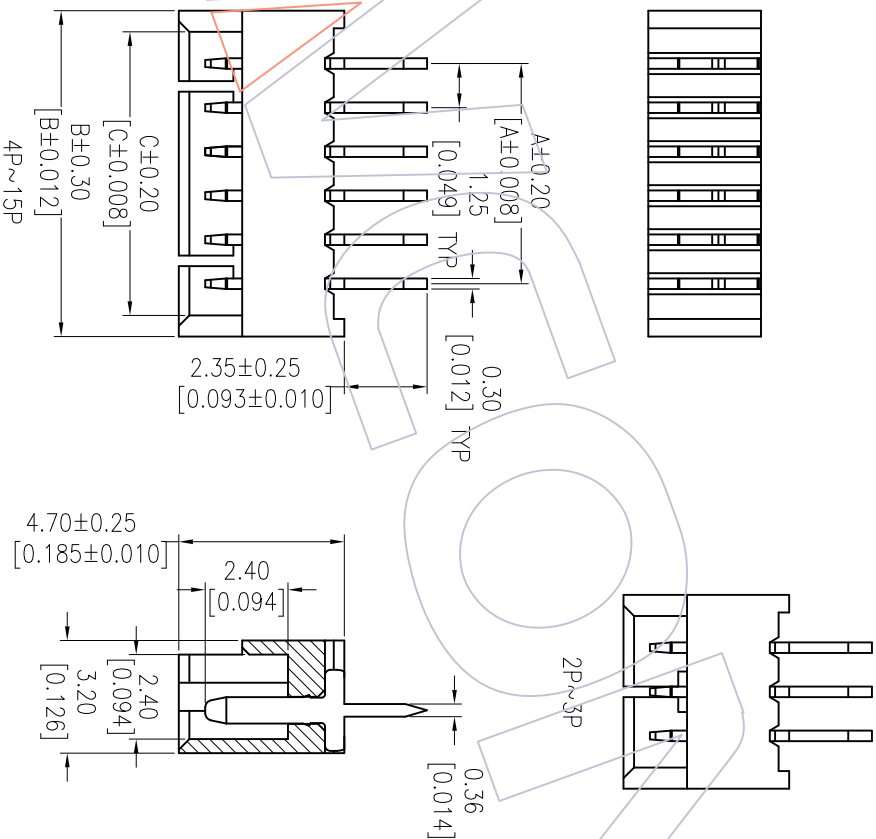

### Specification & Ordering Information:

Circuit	Part No.	Dimension			Q'ty /Tray
		A	B	C	
02	WF1251-WS02XX1	1.25	4.25	3.05	1,000
03	WF1251-WS03XX1	2.50	5.50	4.30	1,000
04	WF1251-WS04XX1	3.75	6.75	5.55	1,000
05	WF1251-WS05XX1	5.00	8.00	6.80	500
06	WF1251-WS06XX1	6.25	9.25	8.05	500
07	WF1251-WS07XX1	7.50	10.50	9.30	400
08	WF1251-WS08XX1	8.75	11.75	10.55	400
09	WF1251-WS09XX1	10.00	13.00	11.80	400
10	WF1251-WS10XX1	11.25	14.25	13.05	300
11	WF1251-WS11XX1	12.50	15.50	14.30	300
12	WF1251-WS12XX1	13.75	16.75	15.55	300
13	WF1251-WS13XX1	15.00	18.00	16.80	200
14	WF1251-WS14XX1	16.25	19.25	18.05	200
15	WF1251-WS15XX1	17.50	20.50	19.30	200

Recommended P.C.B Layout(Top Side)  
(PCB BOARD TOLERANCE±0.05)

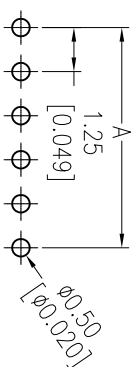

OPERATION	DRAW	DATE	SCALE	FIT	PART NO.
X.X	JYHuang	2014/07/11	mm	1/1	SEE TAB
X.XX	CHECK	DATE	SIZE	A4	TITLE:
X.XXX	APPROVE	DATE	SHEET	1/1	"M" TYPE 1.25 Wafer 180° DIP
Angle	PROU.	DATE	PROU.	1/1	Customer NO.
± 3'					
DIM TOL					

# WCON

WCON-Dongguan Tel: +86 769 85358920  
WCON-Kunshan Tel: +86 512 57468408  
WCON-Huzhou Tel: +86 574 66468408  
WCON-Ningbo Tel: +86 574 66468408  
WCON-Quzhou Tel: +86 574 66468408  
WCON-Taizhou Tel: +86 574 66468408  
WCON-Wenzhou Tel: +86 574 66468408  
WCON-Zhoushan Tel: +86 574 66468408  
WCON-Zhejiang Tel: +86 574 66468408  
WCON-Fujian Tel: +86 574 66468408  
WCON-Guangdong Tel: +86 574 66468408  
WCON-Hubei Tel: +86 574 66468408  
WCON-Hunan Tel: +86 574 66468408  
WCON-Sichuan Tel: +86 574 66468408  
WCON-Shandong Tel: +86 574 66468408  
WCON-Shanghai Tel: +86 574 66468408  
WCON-Tianjin Tel: +86 574 66468408  
WCON-Yunnan Tel: +86 574 66468408  
WCON-Zhejiang Tel: +86 574 66468408