

HSF

NOTES:

Rated Current:3.0A
 Rated Voltage:250V AC/DC
 Contact Resistance:20mΩ max
 Withstand Voltage:800V AC/Minute
 Insulation Resistance:500MΩ min
 Operation Temperature:-25°C to+85°C

Contact Material:Brass
 Contact Plating:Sn over Ni
 Insulator Material:High Temperature Plastic(UL94V-0)

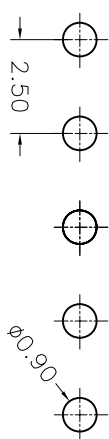

Recommended P.C.B Layout(Top Side)
 (PCB BOARD TOLERANCE±0.05)

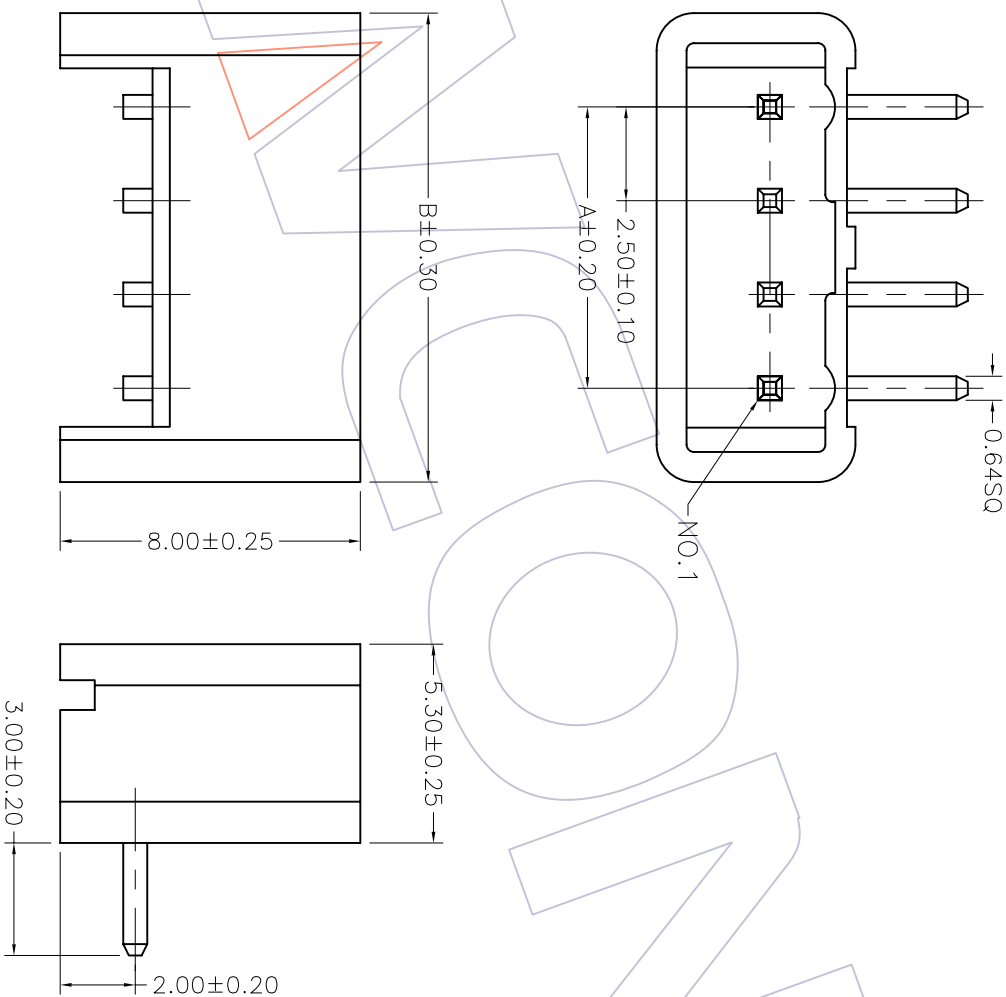

Ordering Information

WF2511 -WR XX X X 1

No. of pins 02P-15P
 Color F=Beige O=PE Bag W=White T=Tube B=Black
 Packing

Dimensional & Ordering Information

Circuit	Part No.	Dimension	
		A	B
02	WF2511-WR02XX1	2.50	7.50
03	WF2511-WR03XX1	5.00	10.00
04	WF2511-WR04XX1	7.50	12.50
05	WF2511-WR05XX1	10.00	15.00
06	WF2511-WR06XX1	12.50	17.50
07	WF2510-WR07XX1	15.00	20.00
08	WF2511-WR08XX1	17.50	22.50
09	WF2511-WR09XX1	20.00	25.00
10	WF2511-WR10XX1	22.50	27.50
11	WF2511-WR11XX1	25.00	30.00
12	WF2511-WR12XX1	27.50	32.50
13	WF2511-WR13XX1	30.00	35.00
14	WF2511-WR14XX1	32.50	37.50
15	WF2511-WR15XX1	35.00	40.00

WCON 维峰五金电子有限公司
 WAVE HARDWARE ELECTRONICS CO. LTD

PART NO. SBE TAB
 TITLE: 2.50 WAFER 90° DIP

OPERATION	XX	±0.25
DESIGN	XXX	±0.15
CHECK	XXX	±0.10
ANGLE	XXX	± 3'
DIM		

DRAW		
WEIXD		
SCALE	1:1	
UNIT	mm	
SIZE	A4	
SHEET	1/1	
PROJ.		

OPERATION	XX	±0.25
DESIGN	XXX	±0.15
CHECK	XXX	±0.10
ANGLE	XXX	± 3'
DIM		

OPERATION	XX	±0.25
DESIGN	XXX	±0.15
CHECK	XXX	±0.10
ANGLE	XXX	± 3'
DIM		

REV	DATE	MODIFICATION DESCRIPTION	CHANGE	APPROVE	OPERATION	DRAW	WEIXD	SCALE	PART NO.
A0	08/08/04	NEW			XXX		08/08/04	1:1	SBE TAB
					XXX				
					XXX				
					XXX				
					XXX				