

# HSF

NOTES:  
 Rated Current: 2.0A  
 Rated Voltage: 250V AC/DC  
 Contact Resistance: 20mΩ max  
 Withstand Voltage: 500V AC/Minute  
 Insulation Resistance: 1000MΩ min  
 Operation Temperature: -25℃ to +85℃  
 Insulation Material: PA66 UL94V-0  
 Use with: WF2003-T (Crimple Terminal)  
 Mated with: WF2003-Wafer

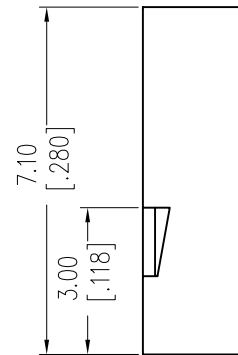
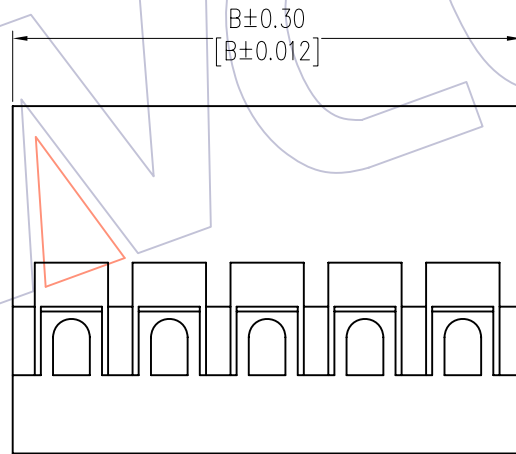
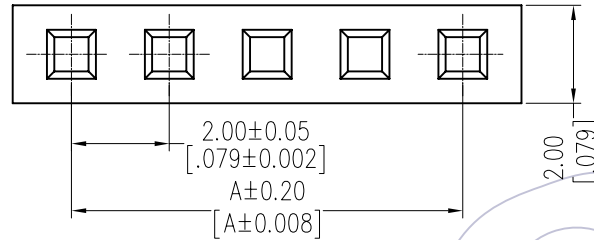

## Ordering Information

WF2003 - 1 H XX X 0 1

No. of Row Single Row  
 No. of pins 01P~40P  
 Color E=Beige W=White B=Black N=Brown  
 Packing 0=PE Bag

Dimensional & Ordering Information

Circuit	Part No.	Dimension	
		A	B
1x02	WF2003-1H02X01	2.00	4.40
1x03	WF2003-1H03X01	4.00	6.40
1x04	WF2003-1H04X01	6.00	8.40
1x05	WF2003-1H05X01	8.00	10.40
1x06	WF2003-1H06X01	10.00	12.40
1x07	WF2003-1H07X01	12.00	14.40
1x08	WF2003-1H08X01	14.00	16.40
1x09	WF2003-1H09X01	16.00	18.40
1x10	WF2003-1H10X01	18.00	20.40
1x11	WF2003-1H11X01	20.00	22.40
1x12	WF2003-1H12X01	22.00	24.40
1x13	WF2003-1H13X01	24.00	26.40
1x14	WF2003-1H14X01	26.00	28.40
1x15	WF2003-1H15X01	28.00	30.40
1x16	WF2003-1H16X01	30.00	32.40
1x17	WF2003-1H17X01	32.00	34.40
1x18	WF2003-1H18X01	34.00	36.40
1x19	WF2003-1H19X01	36.00	38.40
1x20	WF2003-1H20X01	38.00	40.40
1x21	WF2003-1H21X01	40.00	42.40
1x22	WF2003-1H22X01	42.00	44.40
1x23	WF2003-1H23X01	44.00	46.40
1x24	WF2003-1H24X01	46.00	48.40
1x25	WF2003-1H25X01	48.00	50.40
1x26	WF2003-1H26X01	50.00	52.40
1x27	WF2003-1H27X01	52.00	54.40
1x28	WF2003-1H28X01	54.00	56.40
1x29	WF2003-1H29X01	56.00	58.40
1x30	WF2003-1H30X01	58.00	60.40
1x31	WF2003-1H31X01	60.00	62.40
1x32	WF2003-1H32X01	62.00	64.40
1x33	WF2003-1H33X01	64.00	66.40
1x34	WF2003-1H34X01	66.00	68.40
1x35	WF2003-1H35X01	68.00	70.40
1x36	WF2003-1H36X01	70.00	72.40
1x37	WF2003-1H37X01	72.00	74.40
1x38	WF2003-1H38X01	74.00	76.40
1x39	WF2003-1H39X01	76.00	78.40
1x40	WF2003-1H40X01	78.00	80.40

REV	DATE	MODIFICATION DESCRIPTION	CHANGE	OPERATION	DRAW	DATE	SCALE	FIT	PART NO.	TITLE: 2.00 HOUSING	Customer NO.
				X.X ±0.40	JYHuang	2012/09/05	UNIT	mm	SEE TAB		
				X.XX ±0.25	CHECK	DATE	SIZE	inch	A4		
				X.XXX ±0.15	APPROVE	DATE	SHEET	1/1			
				Angle ± 3'			PROJ.				
				DIM TOL							

# WCON

Http: www.wcon.com

WCON-Dongguan Tel: +86 769 85358920 Fax: +86 769 85358915 E-mail: sales@wcon.com  
 WCON-Kunshan Tel: +86 512 57468408 Fax: +86 512 57468468 E-mail: sales@wcon.com