

# HSP

NOTES:  
 Rated Current: 9.0A  
 Contact Resistance: 30mΩ max  
 Withstand Voltage: 1000V AC/Minute  
 Insulation Resistance: 1000MΩ min  
 Operation Temperature: -25°C to +85°C

Contact Material: Brass  
 Contact Plating: Au Or Sn over Ni  
 Insulator Material: PA66

## Ordering Information

WF4202 -1 WR XX W 0 3

No. of Rows: 02-05P  
 Single Row  
 No. of pins: Contact Plating  
 S0=Gold Flash/Tin  
 S3=10u"Gold/Tin  
 S4=15u"Gold/Tin  
 S5=30u"Gold/Tin  
 C0=Gold Flash  
 G3=10u"Gold  
 G4=15u"Gold  
 G5=30u"Gold  
 Blank=Tin  
 Color: B=Black, T=Natural, W=White  
 Packing: O=Pipe Bag, T=Tube

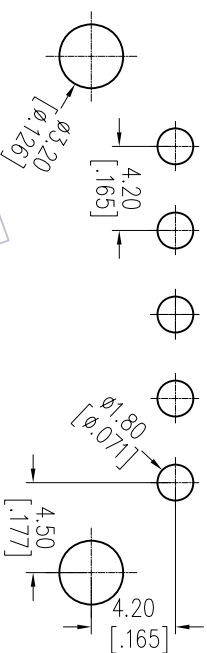
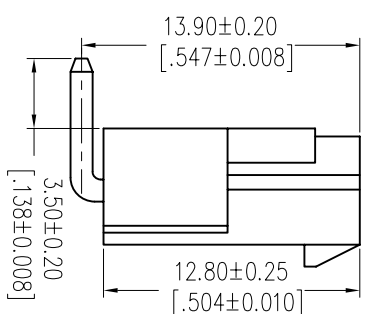
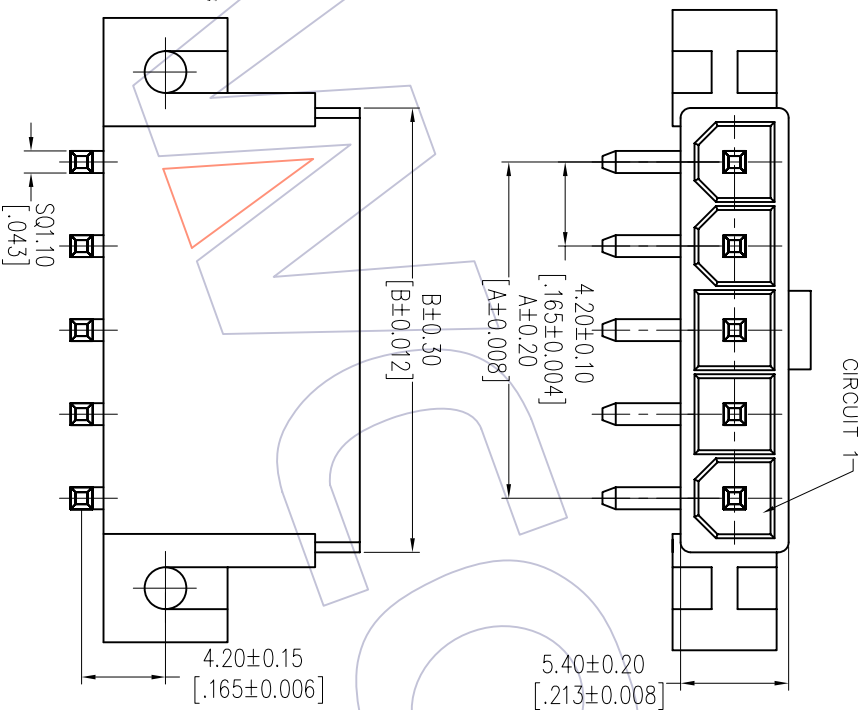

Recommended P.C.B Layout (Top Side)  
 (PCB BOARD TOLERANCE ±0.05)

## Dimensional & Ordering Information

Circuit	Part No.	Dimension	
		A	B
02	WF4202-1WR02WO3	4.20	9.60
03	WF4202-1WR03WO3	8.40	13.80
04	WF4202-1WR04WO3	12.60	18.00
05	WF4202-1WR05WO3	16.80	22.20

OPERATION	SCALE	FIT
XX ±0.40	UNIT	mm
XXX ±0.25	CHECK	A4
XXXX ±0.15	SIZE	1/1
Angle ± 3°	SHEET	PROJ.
	DIM	TOL.

DATE	DATE
2012/09/17	2012/09/17

DATE	DATE
2012/09/17	2012/09/17

DATE	DATE
2012/09/17	2012/09/17

DATE	DATE
2012/09/17	2012/09/17

**WCON**  
 Http: www.wcon.com

WCON-Dongguan Tel: +86 769 85358920  
 WCON-Kunshan Tel: +86 512 57468408  
 Fax: +86 769 85358915 Fax: +86 512 57468468  
 E-mail: sales@wcon.com E-mail: sales@wcon.com

REV	DATE	MODIFICATION DESCRIPTION	CHANGE
AO	2012/09/17	NEW	

1 2 3 4 5 6 7 8 9 10