

HSF

NOTES:
 Rated Current: 9.0AMP
 Contact Resistance: 20mΩ max
 Withstand Voltage: 1500V AC/DC
 Insulation Resistance: 1000MΩ min
 Operation Temperature: -25°C to +85°C
 Insulator Material: PA66 UL94V-2
 Use with: WF4202-T (Female Contact)

No. of pins Color Packing
 02P-05P W=White 0=PE Bag

Ordering Information

WF4202-1 H XX W 0 1

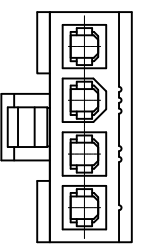
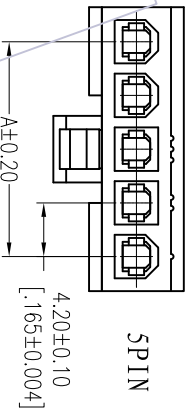
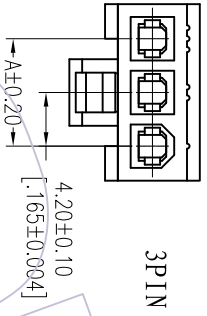
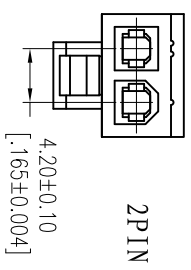
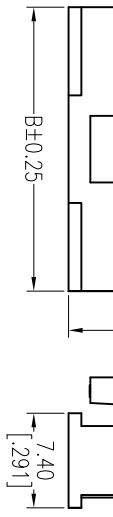
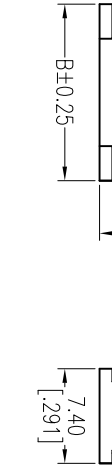
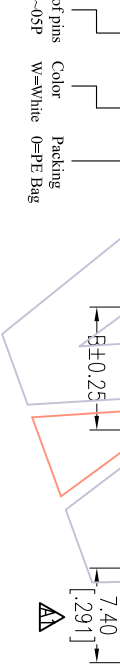

4PIN

2PIN

3PIN

5PIN

Specification & Ordering Information:

Circuit	Part No.	Dimension	
		A	B
02	WF4202-1H02W01	4.20	9.60
03	WF4202-1H03W01	8.40	13.80
04	WF4202-1H04W01	12.60	18.00
05	WF4202-1H05W01	16.80	22.20

WCON

Http: www.wcon.com

WCON-Dongguan Tel: +86 769 85358920
 WCON-Kunshan Tel: +86 512 57468408
 Fax: +86 769 85358915 Fax: +86 512 57468468
 E-mail: sales@wcon.com E-mail: sales@wcon.com

OPERATION	SCALE	FIT	PROJ.
X.X	mm	1/1	
±0.40			
X.XX	A4		
±0.25			
X.XXX	SHEET	1/1	
±0.15			
Angle			
± 3'			
DIM			
TOL			

REV	DATE	MODIFICATION DESCRIPTION	CHANGE
A1	2015/06/24	Modify	
A0	2012/09/17	NEW	

DRAW	DATE	SCALE	PART NO.
JYHuang	2015/06/25	mm	SEE TAB
CHECK	DATE	UNIT	TITLE:
		mm	4.20mm Mini Fit Housing
APPROVE	DATE	SIZE	Single Row Male
		A4	Customer NO.