

HSPF

TECHNICAL SPECS:

Current Rating: 1.0AMP
 Contact Resistance: 10mΩ Max
 Dielectric Strength: Min 500Vrms
 Mechanical Life: Min 500 cycles
 Mating Pin: $\phi 0.38$ to $\phi 0.50$ mm
 Forces: (polished steel gauge $\phi 0.41$ mm)
 Insertion: 150g Max/Pin, Withdrawal: 30g Min/Pin
 Operation Temperature: -40°C to +105°C

Sleeve: Brass CuZn36Pb3(C36000), Sn over Ni
 Contact Clip: (6 finger); BeCu(C17200), Au or Sn over Ni
 Insulator Material: PPS+30%G.F.(UL94V-0)

Ordering Information

3524-383 XX R XX 089 X 1

No. of Pin: 2-50PIN
 Contact Plating: S0=Gold Flash/Tin, S3=10u"Gold/Tin, S4=15u"Gold/Tin, S5=30u"Gold/Tin, SN=Tin
 Packing: A=Tray, T=Tube

Item	Pitch	Mating
Standard	1.27	3514
Alternate		

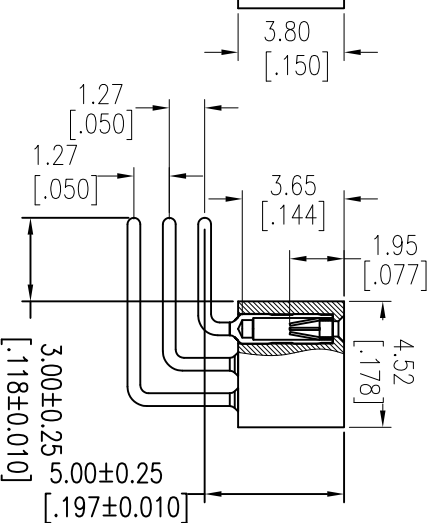
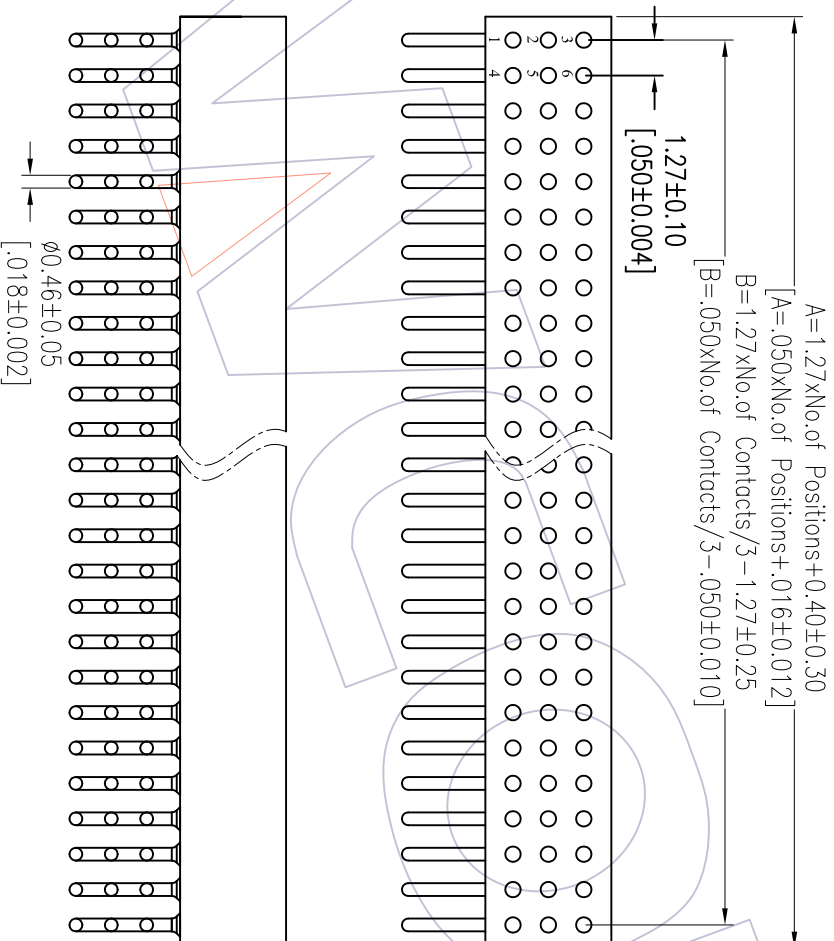
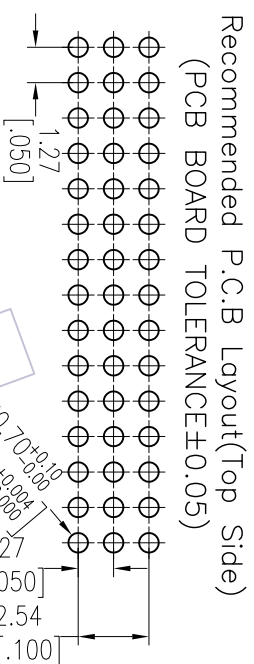

REV	DATE	MODIFICATION DESCRIPTION
A1	2013/01/15	Modify drawing
A0	2012/10/16	NEW

OPERATION	DRAW	DATE	SCALE	FIT	PART NO.
XX	Wang	2013/01/15	UNIT	mm	3524-383XXX089X1
X.XX	CHECK	DATE	SIZE	A4	TITLE:
X.XXX	CHECK	DATE	SHEET	1/1	1.27mm MACHINED FEMALE HEADER
Angle	APPROVE	DATE	PROJ.		THREE ROW 90° H=3.80
DIM	TOL				Customer NO.

WCON

Http: www.wcon.com

WCON-Dongguan
 Tel: +86 769 85358920
 Fax: +86 769 85358915
 E-mail: sales@wcon.com

WCON-Kunshan
 Tel: +86 512 57468408
 Fax: +86 512 57468468
 E-mail: sales@wcon.com