

# HSF

**TECHNICAL SPECS:**

Current Rating: 1.0AMP  
 Contact Resistance: 10m Ω Max  
 Dielectric Strength: Min 500Vrms  
 Mechanical Life: Min 500 cycles  
 Mating Pin:  $\phi 0.38$  to  $\phi 0.50$ mm  
 Forces: (polished steel gauge  $\phi 0.41$ mm)  
 Insertion: 150g Max/Pin, Withdrawal: 30g Min/Pin  
 Operation Temperature:  $-40^{\circ}\text{C}$  to  $+105^{\circ}\text{C}$

Sleeve: Brass CuZn36Pb3(C36000), Sn over Ni  
 Contact Clip(6 finger): BeCu(C17200), Au or Sn over Ni  
 Insulator Material: PPS+30%G.F(UL94V-0)

## Ordering Information

3525-382 XX S XX 060 X 1

No. of Pin: 2-50PIN  
 Contact Plating: SO=Gold Flash/Tin  
 S3=10u"Gold/Tin  
 S4=15u"Gold/Tin  
 S5=30u"Gold/Tin  
 SN=Tin  
 Packing: A=Tray  
 T=Tube

|           |           |        |
|-----------|-----------|--------|
| Item      | Pitch     | Mating |
| Standard  | 1.27X2.54 | 3515   |
| Alternate |           |        |

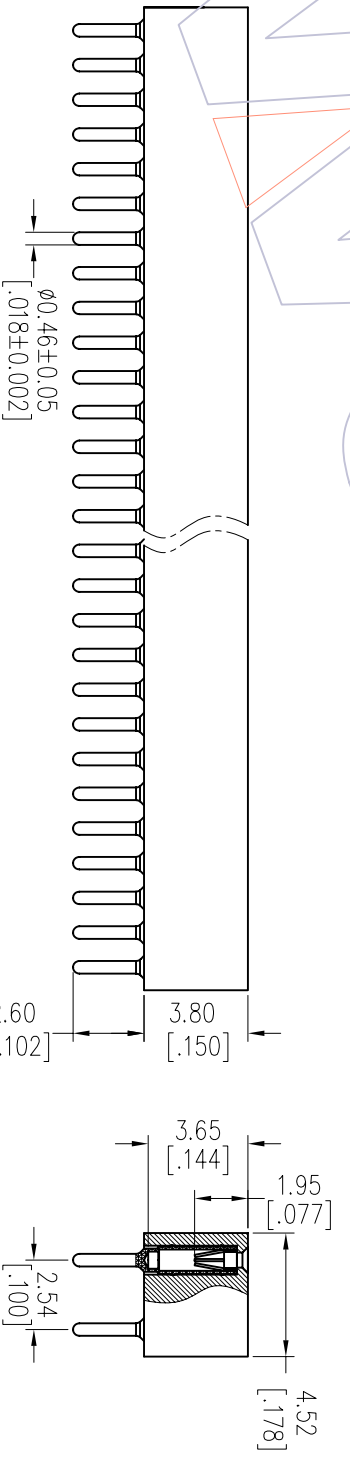
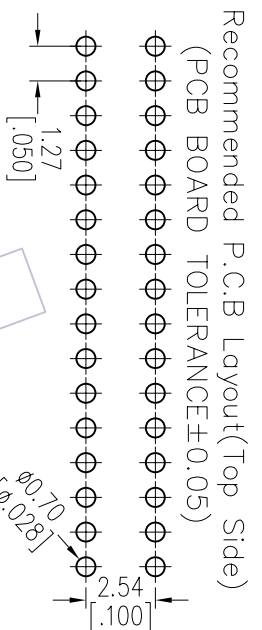
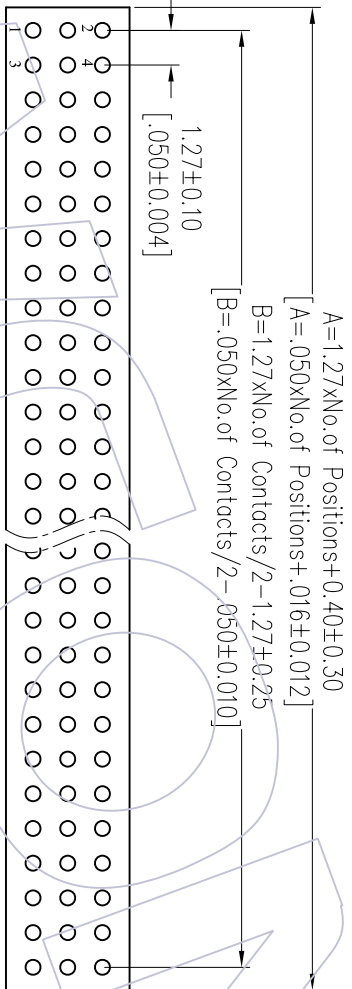

|     |            |                          |            |           |         |            |       |     |                   |  |                        |                        |
|-----|------------|--------------------------|------------|-----------|---------|------------|-------|-----|-------------------|--|------------------------|------------------------|
| REV | DATE       | MODIFICATION DESCRIPTION | CHANGE DIM | OPERATION | DRAW    | DATE       | SCALE | FIT | PART NO.          | TITLE:   | WCON-Dongguan          | WCON-Kunshan           |
| A0  | 2012/10/17 | NEW                      | Angle      | XX        | JYHuang | 2012/10/17 | UNIT  | mm  | 3525-382XXSX060X1 | 1.27x2.54mm MACHINED FEMALE HEADER<br>DUAL ROW 180° Pin Length 6.0mm | Http: www.wcon.com     |                        |
|     |            |                          | ± 3'       | XX        | CHECK   | DATE       | SIZE  | A4  |                   |  | Tel: +86 769 85358920  | Tel: +86 512 57468408  |
|     |            |                          | TOL        | X.XXX     | APPROVE | DATE       | SHEET | 1/1 | Customer NO.      |  | Fax: +86 769 85358915  | Fax: +86 512 57468468  |
|     |            |                          |            | -----     |         |            | PROJ. |     |                   |  | E-mail: sales@wcon.com | E-mail: sales@wcon.com |

# WCON

WCON-Dongguan  
 Tel: +86 769 85358920  
 Fax: +86 769 85358915  
 E-mail: sales@wcon.com

WCON-Kunshan  
 Tel: +86 512 57468408  
 Fax: +86 512 57468468  
 E-mail: sales@wcon.com