

# HSF

**NOTES:**

- Rated Current: 3.0AMP
- Contact Resistance: 20mΩ max
- Withstand Voltage: 1000V AC/DC
- Insulation Resistance: 1000MΩ min
- Operation Temperature: -40°C to +105°C
- Contact Material: Phosphor Bronze
- Contact Plating: Au Over Ni
- Insulator Material: PA9T+30%G.F UL94V-0

## Ordering Information

2135 - 1 XX S XX CUNT 1

- No. of Pins per ROW: 02-40PIN
- Contact Plating:  
 G0=Gold Flash  
 G3=10μ"Gold  
 G4=15μ"Gold  
 G5=30μ"Gold  
 S0=Gold Flash/Tin  
 S3=10μ"Gold/Tin  
 S4=15μ"Gold/Tin  
 S5=30μ"Gold/Tin  
 SN=Tin  
 SM=Mate Tin

Item	Pitch	Mating
Standard	2.54	1115/1120/1125
Alternate		

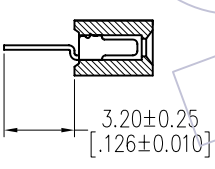
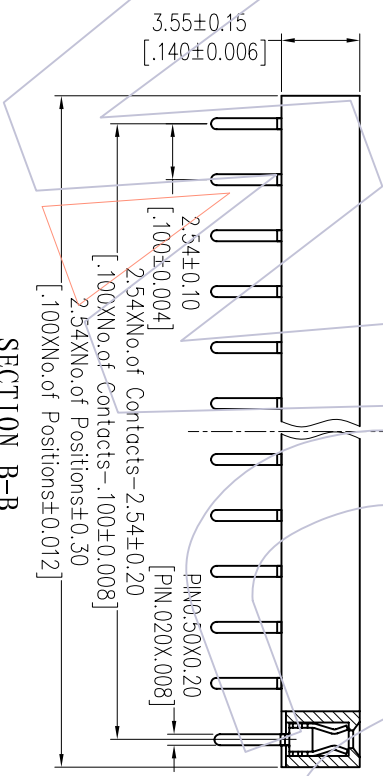
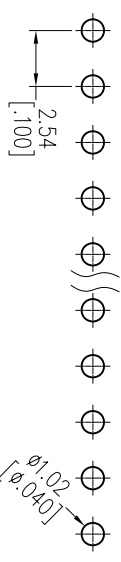
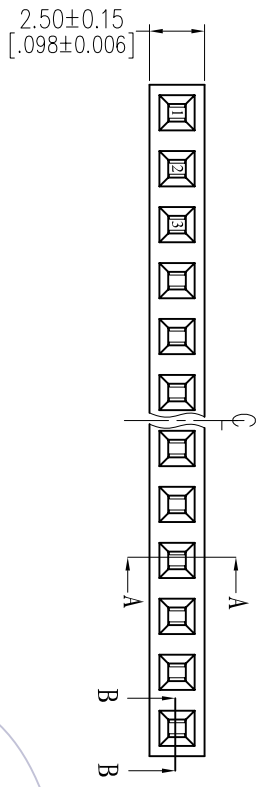

REV	DATE	MODIFICATION DESCRIPTION	CHANGE	DIM	TOL	APPROVE	DATE	SHEET	PROJ.	CUSTOMER NO.
A0	2012/08/02	NEW		Angle	± 3°			1/1		
OPERATION			XX	±0.40		DATE	2012/08/02	UNIT	mm	
DRAW			JYHuang	±0.25		CHECK		SIZE	A4	
TITLE:			FH2.54mm SINGLE ROW 180° DIP							
PART NO.			2135-1XXSXXCUNT1							
SCALE			FIT							
SHEET			1/1							
WCON-Dongguan			WCON-Kunshan							
Tel: +86 769 85358920			Tel: +86 512 57468408							
Fax: +86 769 85358915			Fax: +86 512 57468468							
E-mail: sales@wcon.com			E-mail: sales@wcon.com							

# WCON

Http: www.wcon.com

Recommended P.C.B Layout(Top Side)  
 (PCB BOARD TOLERANCE±0.05)