

# HSE

NOTES:  
 Rated Current:3.0AMP  
 Contact Resistance:20mΩ max  
 Withstand Voltage:1000V AC/DC  
 Insulation Resistance:1000MΩ min  
 Operation Temperature:-40°C to +105°C

Housing Material:LCP+30%G.F.(UL94V-0)  
 Contact Material:Phosphor Bronze  
 Contact plating:Au Or Sn over Ni

## Ordering Information

### 2170T-1XX K XX D UNT 1

No. of Pins  
02-36P

Contact Plating  
G0=Gold Flash  
G3=10μ"Gold  
G4=15μ"Gold  
G5=30μ"Gold

D=LCP  
T=Tube

Packing  
T=Tube

S0=Gold Flash/Tin  
S3=10μ"Gold/Tin  
S4=15μ"Gold/Tin  
S5=30μ"Gold/Tin  
SN=Tin  
SM=Matte Tin

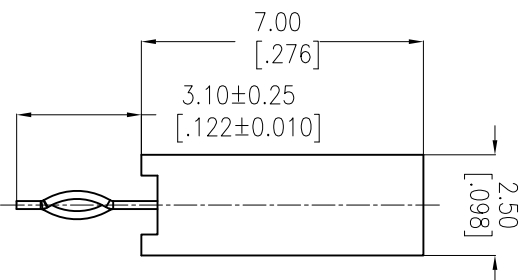
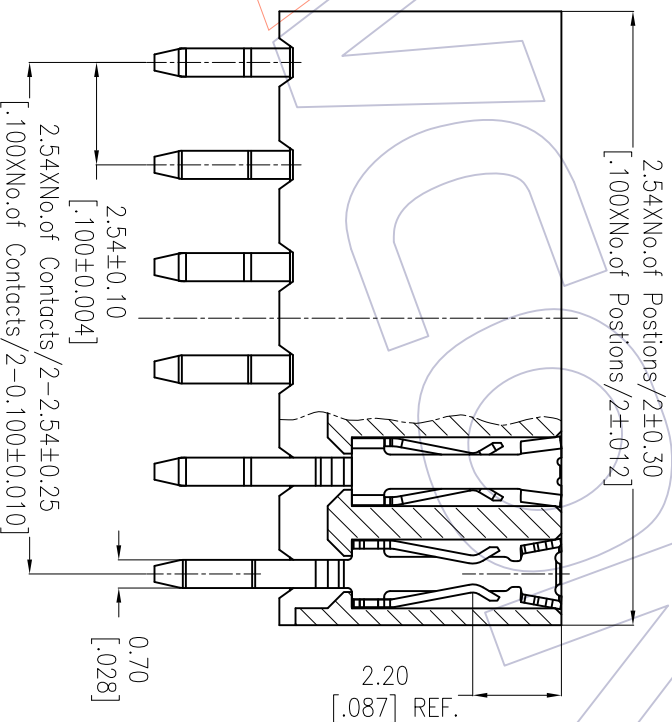
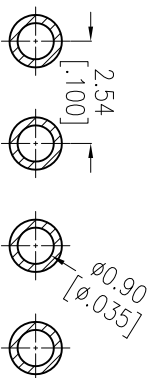
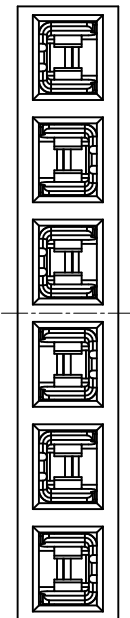

Recommended P.C.B Layout(Top Side)  
 Recommended P.C.B Thickness:1.60  
 (PCB BOARD TOLERANCE±0.05)

REV	DATE	MODIFICATION DESCRIPTION	CHANGE	OPERATION XX ±0.40	DRAW Wang	DATE 2014/06/19	SCALE FIT	PART NO. 2170T-1XXXXXUNT1	<p>WCON-Dongguan Tel: +86 769 85358920 Fax: +86 769 85358915 E-mail: sales@wcon.com</p> <p>WCON-Kunshan Tel: +86 512 57468408 Fax: +86 512 57468468 E-mail: sales@wcon.com</p>
A0	2014/06/19	NEW		X.XX ±0.25	CHECK	DATE	UNIT mm	TITLE: 2.54 PITCH VERTICAL SINGLE ROW DIP CONNECTOR 7.0mm HEIGHT	
REV	DATE	MODIFICATION DESCRIPTION	CHANGE	Angle X.XXX ±0.15	APPROVE	DATE	SIZE A4	CUSTOMER NO.	
1				± 3'			1/1		