

# HSF

**TECHNICAL SPECS:**

Current Rating: 3.0AMP  
 Contact Resistance: 10m Ω Max  
 Dielectric Strength: Min 1000V/RMS  
 Mechanical Life: Min 500 cycles  
 Mating Pin:  $\varnothing 0.7$  to  $\varnothing 0.9$ mm or 0.635SQ  
 Forces: (polished steel gauge  $\varnothing 0.76$ mm)  
 Insertion: 150g Max/Pin, Withdrawal: 30g Min/Pin  
 Operation Temperature:  $-40^{\circ}\text{C}$  to  $+105^{\circ}\text{C}$

Sleeve: Brass CuZn36Pb3(C36000)  
 Contact Clip(6 finger): BeCu(C17200)  
 Insulator Material: PPS+30%G.F(U94V-0)

## Ordering Information

3521-702 XX S XX 140 X 1

No. of Pin: 2-50PIN  
 Contact Plating: S0=Gold Flash/Tin, S3=10u"Gold/Tin, S4=15u"Gold/Tin, S5=30u"Gold/Tin, SN=Tin  
 Packing: A=Tray, T=Tube

|           |       |        |
|-----------|-------|--------|
| Item      | Pitch | Mating |
| Standard  | 2.54  | 3511   |
| Alternate |       |        |

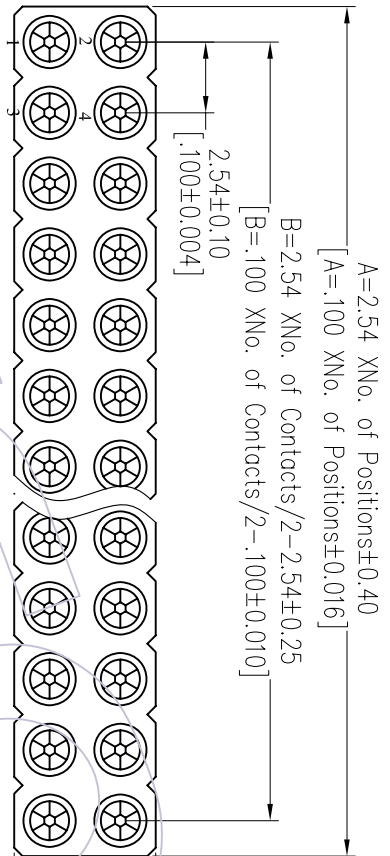

Recommended P.C.B Layout(Top Side)  
 (PCB BOARD TOLERANCE ±0.05)

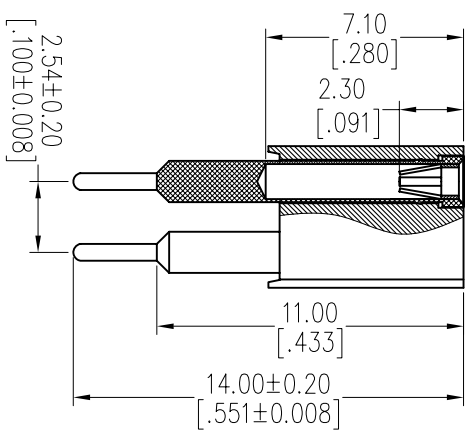
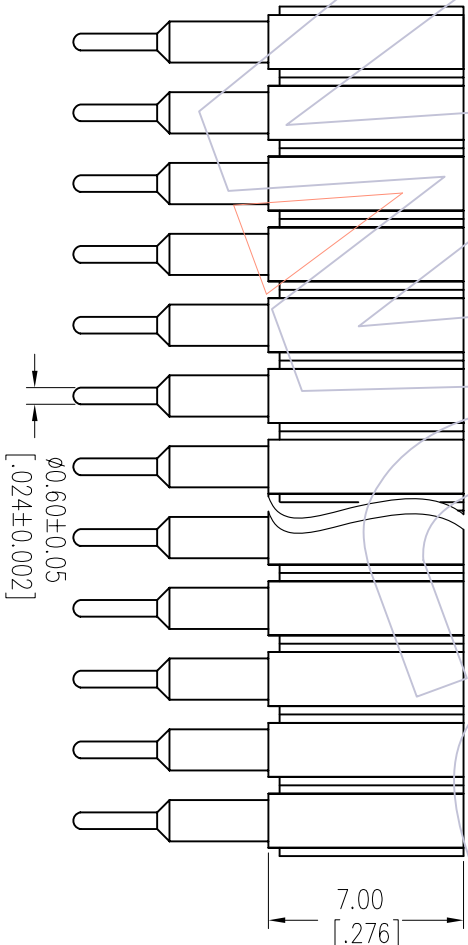
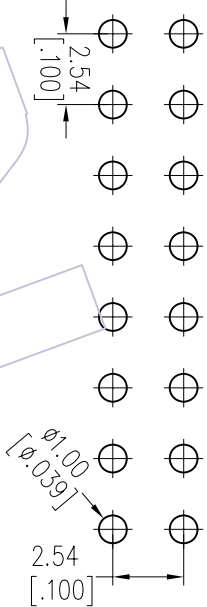

|     |            |                          |        |           |         |            |       |     |                    |  |   |  |
|-----|------------|--------------------------|--------|-----------|---------|------------|-------|-----|--------------------|--|---|--|
| REV | DATE       | MODIFICATION DESCRIPTION | CHANGE | OPERATION | DRAW    | DATE       | SCALE | FIT | PART NO.           | TITLE:<br>2.54mm MACHINED FEMALE HEADER<br>DUAL ROW 180° H=7.00 L=14.0<br>Customer NO. | WCON-Dongguan<br>Tel: +86 769 85358920<br>Fax: +86 769 85358915<br>E-mail: sales@wcon.com | WCON-Kunshan<br>Tel: +86 512 57468408<br>Fax: +86 512 57468468<br>E-mail: sales@wcon.com |
| A0  | 2012/10/18 | NEW                      | ---    | XX        | JYHuang | 2012/10/18 | mm    | A4  | 3521-702XXSXX140X1 |  |   |  |
| REV | DATE       | MODIFICATION DESCRIPTION | CHANGE | OPERATION | DRAW    | DATE       | SCALE | FIT | PART NO.           | WCON<br>Http: www.wcon.com   |   |  |