

# HSF

NOTES:  
 Current Rating: 3.0AMP  
 Contact Resistance: 20mΩ Max  
 Withstand Voltage: 500V AC/Minute  
 Insulation Resistance: 1000MΩ Min  
 Operation Temperature: -40°C to +105°C

Contact Material: Phosphor Bronze/Brass  
 Contact plating: Au Or Sn over Ni  
 Insulator Material: PBT+30%G.F UL94V-0  
 Shell: Cold Roller Steel, Sn Or Ni Plated  
 Nut: Brass, Sn Over Ni Plated

## Ordering Information

6212A-XX M X XX B 01

No. of Pins 15, 26, 44, 62P  
 Type Y=With Back Fork S0=Gold Flash/Tin B:Black  
 B=With Back Nut S3=10u"Gold/Tin U:Blue  
 F=With Front Nut S4=15u"Gold/Tin  
 H=With Back Fork S5=30u"Gold/Tin  
 With Screw SN=Tin  
 N=Without Fork  
 Without Nut

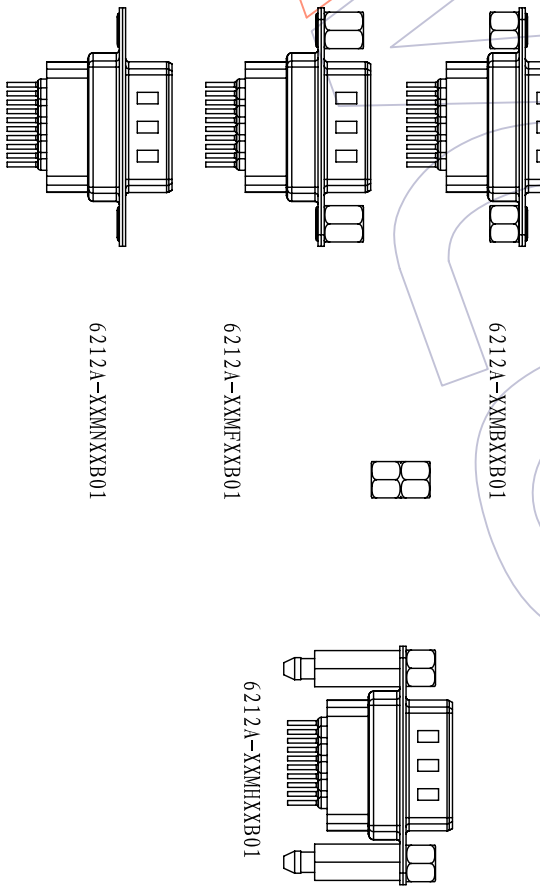
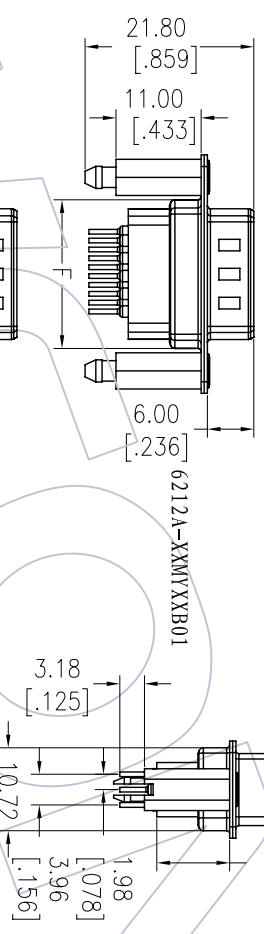
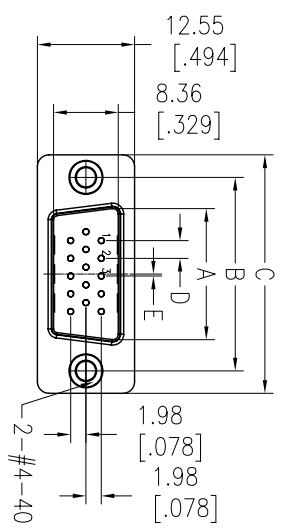

Recommended P.C.B Layout(Top Side)  
 (PCB BOARD TOLERANCE±0.05)

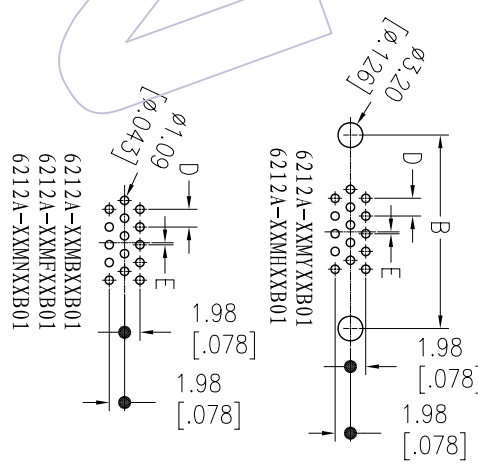

No. of Positions	DIM "A"	DIM "B"	DIM "C"	DIM "D"	DIM "E"	DIM "P"
15	16.92	24.99	30.81	19.28	7.04	2.29
26	25.25	33.32	39.14	27.65	6.88	2.29
44	38.96	47.04	53.04	41.30	6.88	2.29
62	55.42	63.50	69.32	57.44	6.99	2.41

# WCON

Http: www.wcon.com

WCON-Dongguan Tel: +86 769 85358920 Fax: +86 769 85358915 E-mail: sdles@wcon.com  
 WCON-Kunshan Tel: +86 512 57468408 Fax: +86 512 57468468 E-mail: sdles@wcon.com

REV	DATE	MODIFICATION DESCRIPTION	CHANGE	OPERATION	DRAW	DATE	SCALE	FIT	PART NO.	TITLE:	Customer NO.
AO	2012/12/04	NEW		XX	JYHuang	2012/12/04	mm	A4	6212A-XXMXXB01	HD-SUB MALE THREE ROW 180° DIP	
				X.XXX	CHECK	DATE	SIZE	SHEET			
				X.XXX	APPROVE	DATE	1/1	PROU.			
				Angle	± 3'						
				DIM	TOL						