

HSF

NOTES:

- Current Rating: 3.0AMP
- Contact Resistance: 20mΩ Max
- Withstand Voltage: 1000V AC/DC
- Insulation Resistance: 1000MΩ Min
- Operation Temperature: -40°C to +105°C
- Contact Material: Brass
- Contact plating: Au Or Sn over Ni
- Latch Material: Zinc Alloy
- Latch plating: Ni
- Insulator Material: PBT or PA9T+30%GF UL94V-0
- Above 20 Poles With "E" Profile.

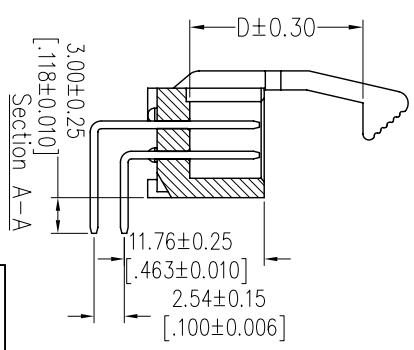
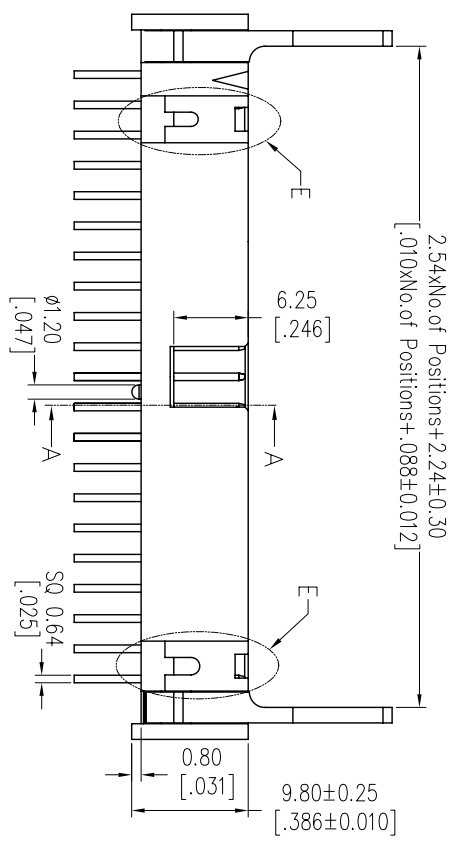
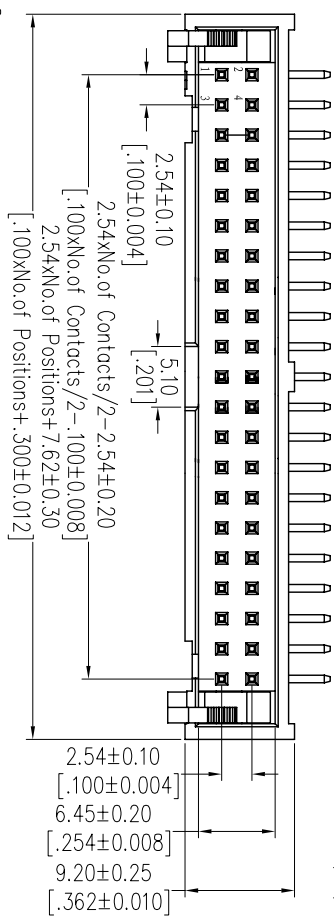
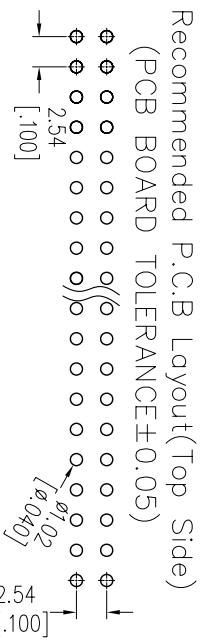

Ordering Information

3211-XX R XX B X X 1

- No. of Pins
- Contact Plating: G0=Gold Flash, G3=10µ"Gold, G4=15µ"Gold, G5=30µ"Gold, S0=Gold Flash/Tin, S3=10µ"Gold/Tin, S4=15µ"Gold/Tin, S5=30µ"Gold/Tin, SN=Tin
- Insulator Color: B=Black, U=Blue, G=Grey(427C), E=Grey(413C)
- Latch Type: L=Long Latch, S=Short Latch
- Packing: A=Tray, T=Tube

Item	Pitch	Mating
Standard	2.54	5211/5212
Alternate		

PART NO	D
3211-XXRXXBLX1	14.55
3211-XXRXXBSX1	10.65

REV	DATE	MODIFICATION DESCRIPTION
A0	2012/10/08	NEW

OPERATION	DRAW	DATE	SCALE	FIT
XX ±0.40	JYHuang	2012/10/08	mm	A4
X.XX ±0.25	CHECK	DATE	SIZE	A4
X.XXX ±0.15	Angle	± 3°	SHEET	1/1
DIW	TOL	APPROVE	PROJ.	

PART NO.	SBB TAB
TITLE: 2.54 EJECTOR HEADER 90° METAL LATCH	Customer NO.

WCON

Http: www.wcon.com

WCON-Dongguan Tel: +86 769 85358920 Fax: +86 769 85358915 E-mail: sales@wcon.com	WCON-Kunshan Tel: +86 512 57468408 Fax: +86 512 57468468 E-mail: sales@wcon.com
---	--