

# HSF

Recommended P.C.B Layout (Top Side)  
(PCB BOARD TOLERANCE±0.05)

NOTES:  
Rated Current:3.0AMP.  
Contact Resistance:20mΩ Max.  
Withstand Voltage:1000V AC/DC  
Insulation Resistance:1000MΩ Min.  
Operation Temperature:-40°C to +105°C

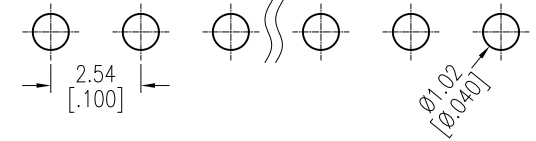
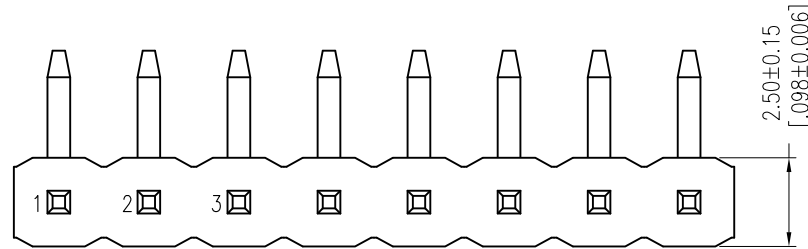

Contact Material:Brass  
Contact Plating:Au or Sn Over Ni  
Insulator Material:PA9T+33%G.F UL94V-0 BK

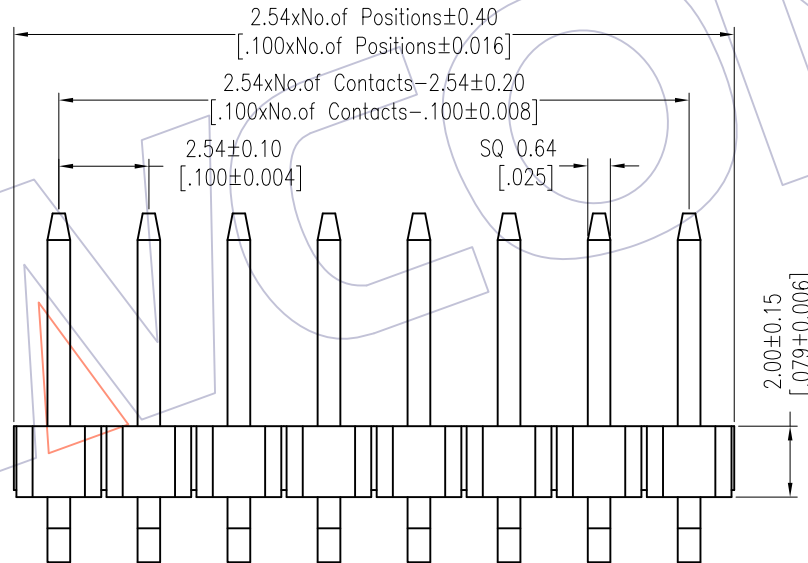

## Ordering Information

1120-11 XX XX R XXX C 0 XX A1

No. of Pins	Contact Plating	Pin Length	Insulator Material	Packing	Series No.
02-40	G0=Gold Flash G3=10u"Gold G4=15u"Gold G5=30u"Gold S0=Gold Flash/Tin S3=10u"Gold/Tin S4=15u"Gold/Tin S5=30u"Gold/Tin SN=Tin SM=Matte Tin	L=A+B+D+3.2 Standard:134=13.4	C=PA9T	0=PE Bag T=Tube	01-99

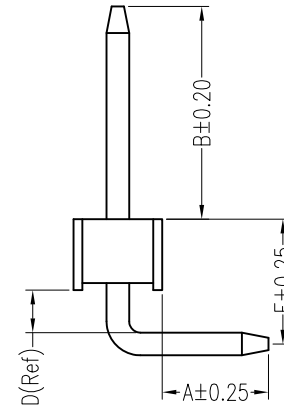

Item	Pin Length	A	E	B	Mating
Standard	13.40	3.00	3.52	6.00	2171 2185
Alternate					

REV	DATE	MODIFICATION DESCRIPTION	CHANGE	OPERATION		DRAW	DATE	SCALE	Fit	PART NO.
				x.x	±0.40					
A1	2018/01/22	Modify P/N	A1	x.xx	±0.25	CHECK	DATE	SIZE	A4	TITLE: PH2.54 SINGLE ROW 90°H=2.0 CONCAVE BENDING
A0	2012/05/07	NEW	-----	x.xxx	±0.15	APPROVE	DATE	SHEET	1/1	Customer NO.
				Angle	± 3'			PROJ.	☉	
				DIM	TOL					

# WCON

Http: www.wcon.com

WCON-Dongguan Tel: +86 769 85358920 Fax: +86 769 85358915 E-mail: sales@wcon.com	WCON-Kunshan Tel: +86 512 57468408 Fax: +86 512 57468468 E-mail: salesks@wcon.com
---	--