

HSF

Recommended P.C.B Layout (Top Side)
(PCB BOARD TOLERANCE ±0.05)

NOTES:
 Rated Current: 3.0AMP.
 Contact Resistance: 20mΩ Max.
 Withstand Voltage: 1000V AC/DC
 Insulation Resistance: 1000MΩ Min.
 Operation Temperature: -40°C to +105°C

Contact Material: Brass
 Contact Plating: Au or Sn Over Ni
 Insulator Material: PA9T+33%G.F UL94V-0 BK

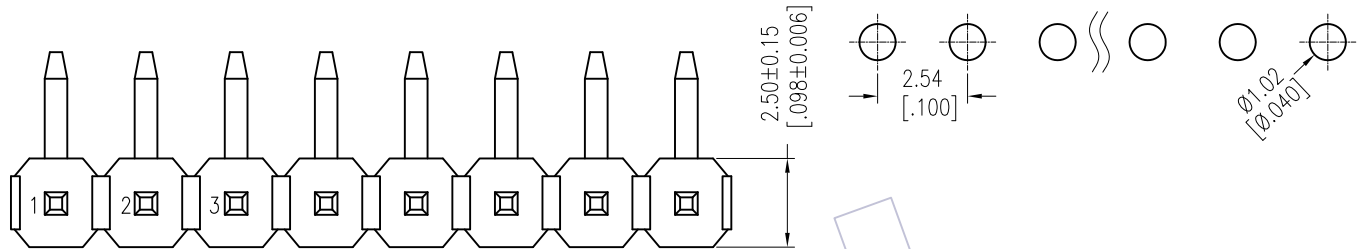

Ordering Information

1117-11 XX XX R XXX C 0 XX $\triangle A1$

No. of Pins	Contact Plating	Pin Length	Insulator Material	Packing	Series No.
02-40	G0=Gold Flash G3=10u"Gold G4=15u"Gold G5=30u"Gold S0=Gold Flash/Tin S3=10u"Gold/Tin S4=15u"Gold/Tin S5=30u"Gold/Tin SN=Tin SM=Matte Tin	L=A+B+D+2.9 Standard: 131=13.1	C=PA9T	0=PE Bag T=Tube	01-99

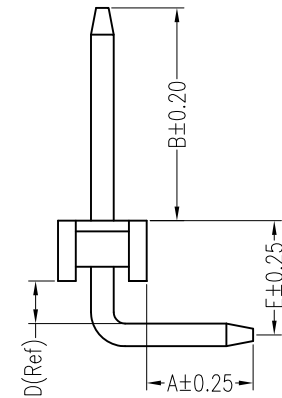
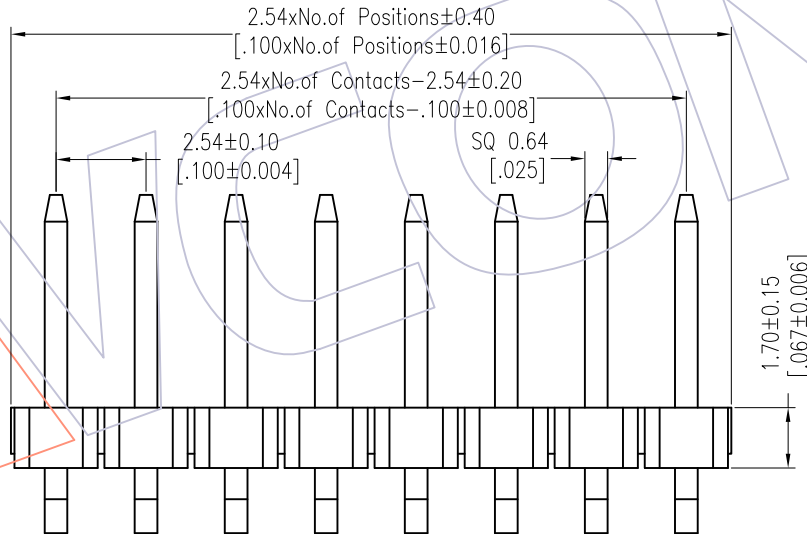

Item	Pin Length	A	E	B	Mating
Standard	13.10	3.00	3.22	6.00	2171 2185
Alternate					

REV	DATE	MODIFICATION DESCRIPTION	CHANGE	OPERATION		DRAW	DATE	SCALE	Fit	PART NO.
				x.x	±0.40					
A1	2018/01/22	Modify P/N	$\triangle A1$	x.xx	±0.25	CHECK	DATE	SIZE	A4	TITLE:
A0	2012/05/04	NEW	-----	x.xxx	±0.15	APPROVE	DATE	SHEET	1/1	PH2.54 SINGLE ROW 90°H=1.7 CONCAVE BENDING
				Angle	± 3'			PROJ.	ϕ	Customer NO.
				DIM	TOL					

WCON

Http: www.wcon.com

WCON-Dongguan Tel: +86 769 85358920 Fax: +86 769 85358915 E-mail: sales@wcon.com	WCON-Kunshan Tel: +86 512 57468408 Fax: +86 512 57468468 E-mail: salesks@wcon.com
---	--