

HSF

Recommended P.C.B Layout (Top Side)
(PCB BOARD TOLERANCE±0.05)

NOTES:
Rated Current:7.0AMP.
Contact Resistance:20mΩ Max.
Withstand Voltage:1000V AC/DC
Insulation Resistance:1000MΩ Min.
Operation Temperature:-40°C to +105°C

Contact Material:Brass
Contact Plating:Au or Sn Over Ni
Insulator Material:LCP+30%G.F UL94V-0 BK(Std)
or PA9T+33%G.F UL94V-0 BK

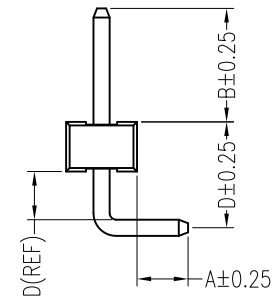
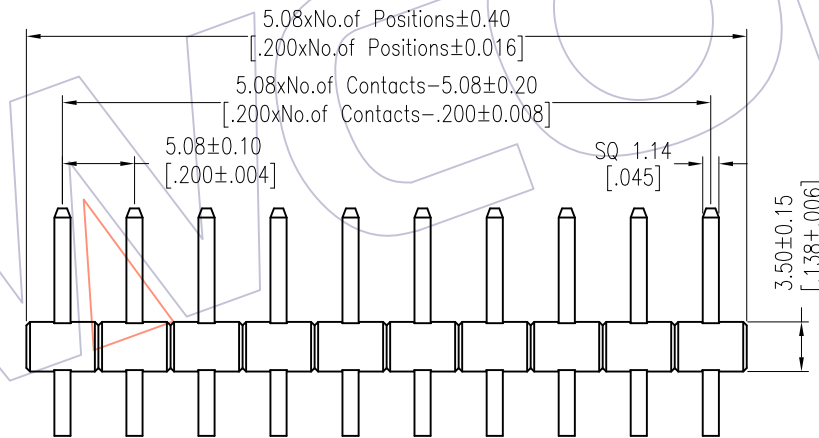
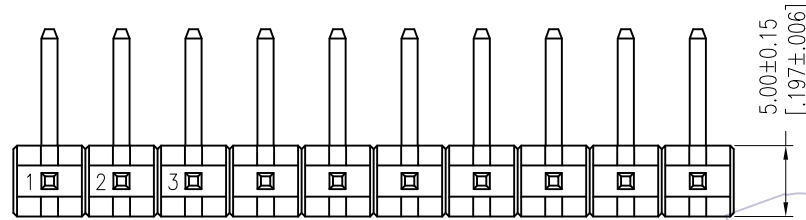
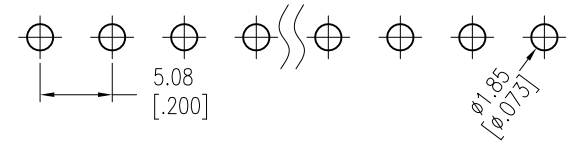

Ordering Information

1935-11 XX XX R XXX X 0 XX

No. of Pins	Contact Plating	Pin Length	Insulator	Packing	Series No.
01~20	G0=Gold Flash SN=Tin SM=Matte Tin	L=A+B+D+6.0	C=PA9T D=LCP	0=PE Bag	01~99

Item	Pin Length	A	E	B	Mating
Standard	21.0	3.60	7.47	8.00	2989
Alternate					

REV	DATE	MODIFICATION DESCRIPTION	CHANGE	OPERATION	DRAW	DATE	SCALE	Fit	PART NO.
				x.X ±0.40	William Chen	2018/01/26	UNIT	mm [inch]	1935-11XXXXRXXXXXX
A1	2018/01/26	MODIFY PART NO.	-----	x.XX ±0.25	CHECK	DATE	SIZE	A4	TITLE:
A0	2012/07/06	NEW	-----	x.XXX ±0.15	APPROVE	DATE	SHEET	1/1	5.08 Pin Header, SINGLE ROW, R/A, H=3.5
				Angle ± 3'			PROJ.	Customer NO.	
				DIM TOL					

WCON

Http: www.wcon.com

WCON-Dongguan Tel: +86 769 85358920 Fax: +86 769 85358915 E-mail: sales@wcon.com	WCON-Kunshan Tel: +86 512 57468408 Fax: +86 512 57468468 E-mail: salesks@wcon.com
---	--