

# HSF

Recommended P.C.B Layout (Top Side)  
(PCB BOARD TOLERANCE±0.05)

NOTES:  
 Rated Current:7.0AMP.  
 Contact Resistance:20mΩ Max.  
 Withstand Voltage:1000V AC/DC  
 Insulation Resistance:1000MΩ Min.  
 Operation Temperature:-40°C to +105°C

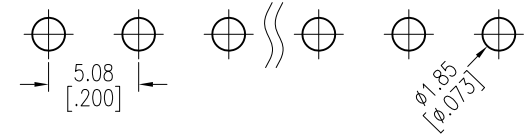
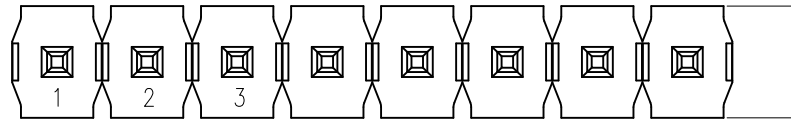

Contact Material:Brass  
 Contact Plating:Au or Sn Over Ni  
 Insulator Material:LCP+30%G.F UL94V-0 BK

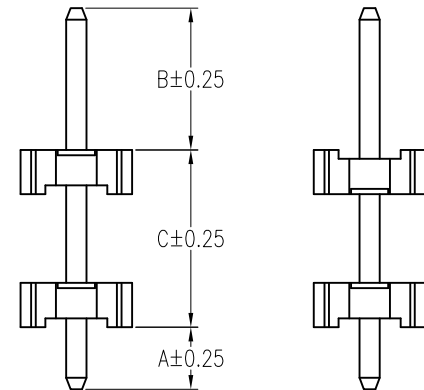
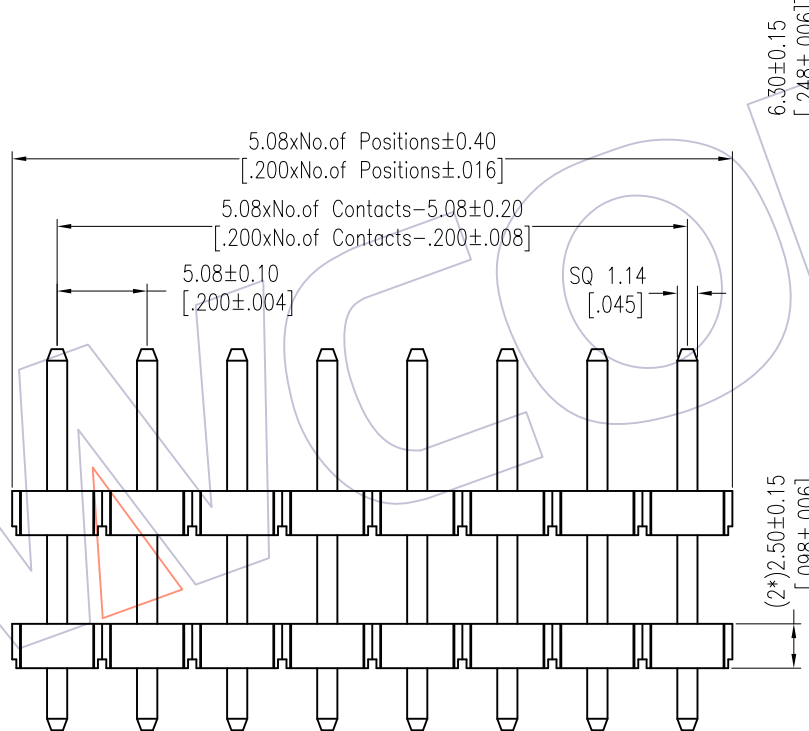

## Ordering Information

1925-21 XX XX S XXX D 0 XX

No.of Pins    Contact Plating    Pin Length    Insulator    Packing    Series No.  
 01~20    G0=Gold Flash    L=A+B+C    D=LCP    0=PE Bag    01~99  
 SN=Tin  
 SM=Matte Tin

Item	Pin Length	A	B	C	Mating
Standard	--	3.50	8.00	--	2989
Alternate					

REV	DATE	MODIFICATION DESCRIPTION	CHANGE	OPERATION	DRAW	DATE	SCALE	Fit	PART NO.
				x.X    ±0.40	William Chen	2018/01/26	UNIT	mm [inch]	1925-21XXXXXXDXDX Δ
A1	2018/01/26	MODIFY PART NO.	-----	x.XX    ±0.25	CHECK	DATE	SIZE	A4	TITLE:
A0	2012/07/03	NEW	-----	x.XXX    ±0.15	APPROVE	DATE	SHEET	1/1	5.08 Pin Header, SINGLE ROW, S/T, DOUBLE PLASTIC, H=2.5
				Angle    ± 3'			PROJ.	⊕	Customer NO.
				DIM    TOL					

# WCON

Http: www.wcon.com

WCON-Dongguan    WCON-Kunshan  
 Tel: +86 769 85358920    Tel: +86 512 57468408  
 Fax: +86 769 85358915    Fax: +86 512 57468468  
 E-mail: sales@wcon.com    E-mail: salesks@wcon.com